

**DVD VCD CD MP3**

*Lanzar*<sup>®</sup>



**DVD**

**Operating  
Instructions**

**Half Din DVD/CD/MP3 Player  
SD.51N**



Thank you for purchasing 1/2 DIN DVD player. Please read this manual carefully before operating and reserve it for future reference. It will be helpful to you if you encounter any operational problem.

**WARNING:** TO REDUCE THE RISK OF FIRE OR ELECTRIC SHOCK, DO NOT EXPOSE THIS APPLIANCE TO RAIN OR MOISTURE, DRIPPING OR SPLASHING AND THAT NO OBJECTS FILLED WITH LIQUIDS, SUCH AS VASES, SHALL BE PLACED ON THE APPARATUS. DANGEROUS HIGH VOLTAGES ARE PRESENT INSIDE THE ENCLOSURE. DO NOT OPEN THE CABINET. REFER SERVICING TO QUALIFIED PERSONNEL ONLY.

**ATTENTION:** TO PREVENT ELECTRIC SHOCK, MATCH WIDE BLADE OF PLUG TO WIDE SLOT, FULLY INSERT.

## Keypad in the main unit



### 1 Power button

Power on/off the unit

### 2 Stop button

Press this to stop play mode

### 3 Play/Pause/On button

Press this to play disc. When press this in the play mode, pause mode is set. Press again to resume playback.

### 4 IR

Remote control incept window

### 5 Previous/Next buttons

Using these buttons to scan forward or backward through the tracks or chapters.

### 6 Eject button

Press this button to eject the disc when a disc is in the main unit

### 8 Remote sensor

Remote control incept the induce jack. When the remote control connect the inductor. It's can receive the IR signal from the remote control.



### 7 Power

DC 12V, 1.5A input

#### Notes:

Red wire: REM

Yellow wire: DC 12V

Black wire: GND

### 9 Audio output R

### 10 Audio output L

### 11 Video output

### 12 OPTCAL output

# CONNECTING THE PLAYER TO OTHER COMPONENTS

3

## Before connecting

Turn off the power of the player and the devices to be connected.

## Connecting to a TV set

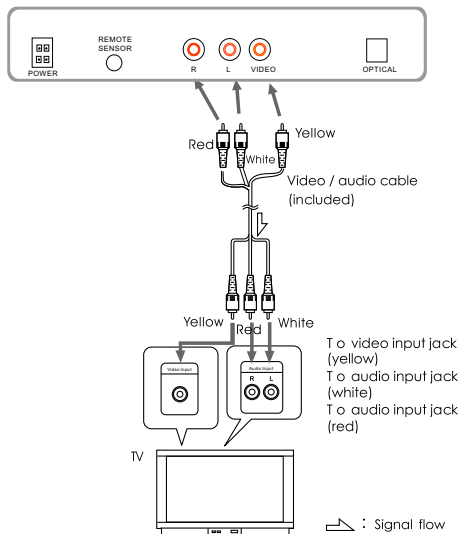

# CONNECTING THE PLAYER TO OTHER COMPONENTS

## Connecting to a digital amplifier that is not Dolby Digital / DTS / MPEG compatible

### Notes:

**Do not play DVDs when the audio settings are not correct. Or may cause strong noise and damage your speakers.**

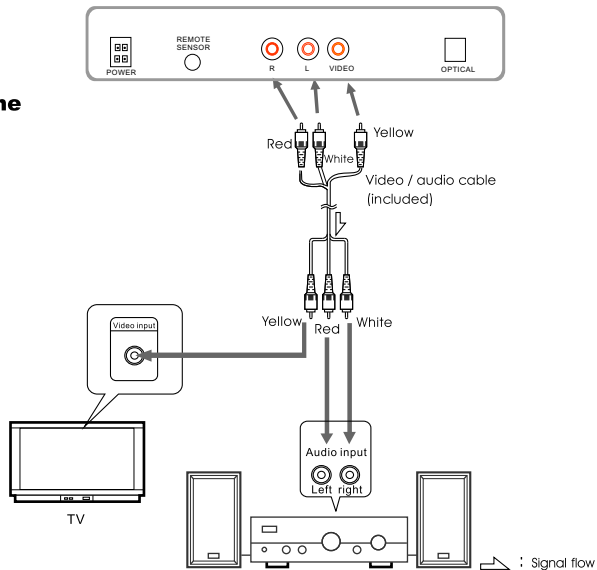

# CONNECTING THE PLAYER TO OTHER COMPONENTS

5

## Connecting to active speaker systems

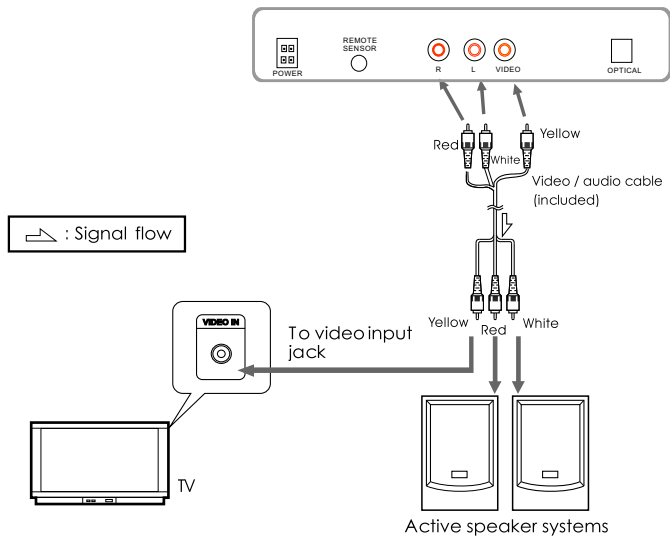

## Remote control unit

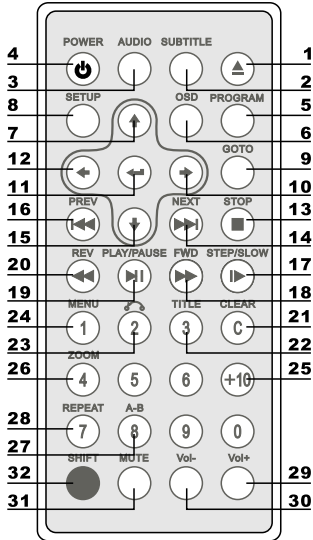

- 1 EJECT**  
Eject the disc
- 2 SUBTITLE**  
Selecting sub-title
- 3 AUDIO**  
DVD: selecting audio language  
VCD or CD: Selecting the audio channel
- 4 POWER**  
Power on/off the unit
- 5 PROGRAM**  
Programming the play sequence
- 6 OSD**  
Press this buttons to display the disc and playing information in the LCD
- 7 ↑**  
Moving cursor Up
- 8 SETUP**  
Set up menu when the unit in play mode
- 9 GOTO**  
Selecting the Title/Chapter/Time to play
- 10 →**  
Moving cursor Right

## Remote control unit

- 11** ←  
this to confirm settings
- 12** ←  
Moving cursor left
- 13** **STOP**  
Stop playing disc
- 14** **NEXT**  
Skip next track/chapter
- 15** ↓  
Moving cursor down
- 16** **PREV**  
Skip previous track/chapter
- 17** **STEP/SLOW**  
Press this to enter slowing play when the unit in play mode  
Press this to step one frame when the unit in pause mode
- 18** **Forward**  
Press this to fast forward play when the unit in play mode
- 19** **PLAY/PAUSE**  
Press this to play or pause
- 20** **REV**  
Press this to fast backward play when the unit in play mode
- 21** **CLEAR**  
Clearing the digit that is just input
- 22** **TITLE**  
Displaying DVD title
- 23** ↶  
Return to menu.
- 24** **MENU**  
Menu play
- 25** **DIGIT INPUT**
- 26** **ZOOM**  
Zooming the picture
- 27** **A-B**  
Press this to set A point, press again to set B point, then the unit playing from A to B repeated.  
Press 3<sup>rd</sup> to cancel the A-B play.
- 28** **REPEAT**  
DVD: repeat play the title, chapter VCD,CD: repeat the track or whole disc
- 29** **VOL+**  
Increasing the volume
- 30** **VOL-**  
Decreasing the volume
- 31** **MUTE**  
Switch off the speakers or earphone
- 32** **SHIFT**  
Switching the Digit or Function for the multi-function key



## Replacing the battery

- 1** Insert your finger nails into A and B on the diagram below, press A according to the direction, then pull out the battery holder.

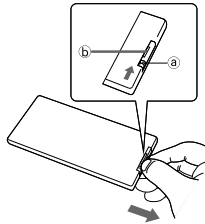

- 2** Remove the old battery, then insert the new battery into the battery holder with the + side facing upwards.

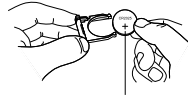

Lithium battery (Cr2025)

- 3** Fit the battery holder back to its place.

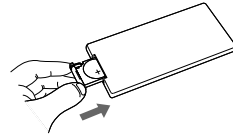

### Note:

To prevent leakage of fluid from the lithium battery, remove the battery when not using the remote control unit for long periods of time (one month or more). If the battery leaks fluid, carefully wipe it out of the battery case, then change to a new lithium battery.

